

123 MAIN ST., CITY, ST, 00000

Report: SAMPLE

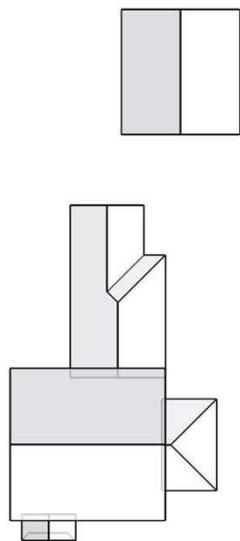

In this 3D model, facets appear as semi-transparent to reveal overhangs.

PREPARED FOR

Contact:	Contact Here
Company:	Company
Address:	123 Main ST. N City, ST, 00000
Phone:	555-555-5555

TABLE OF CONTENTS

Images	1
Length Diagram	4
Pitch Diagram	5
Area Diagram	6
Notes Diagram	7
3D Wall Area Diagram	8
Alternate 3D Wall View	9
Window and Door Diagram	10
Elevation Diagrams	12
Report Summary	18
Wall Report Summary	20

MEASUREMENTS

Total Roof Area = 2,387 sq ft
 Total Roof Facets = 14
 Predominant Pitch = 7/12
 Number of Stories > 1
 Total Ridges/Hips = 132 ft
 Total Valleys = 11 ft
 Total Rakes = 144 ft
 Total Eaves = 232 ft
 Total Wall Area = 3,231 sq ft
 Total Wall Facets = 17

Measurements provided by www.eagleview.com



Certified Accurate
Certified accuracy on all roof reports.



Satisfaction Guaranteed
Satisfaction guaranteed on all wall reports.

123 MAIN ST., CITY, ST, 00000

Report: SAMPLE

IMAGES

The following aerial images show different angles of this structure for your reference.

Top View



IMAGES

North Side



South Side



123 MAIN ST., CITY, ST, 00000

Report: SAMPLE

IMAGES

East Side



West Side



PITCH DIAGRAM

Pitch values are shown in inches per foot, and arrows indicate slope direction. The predominant pitch on this roof is 7/12

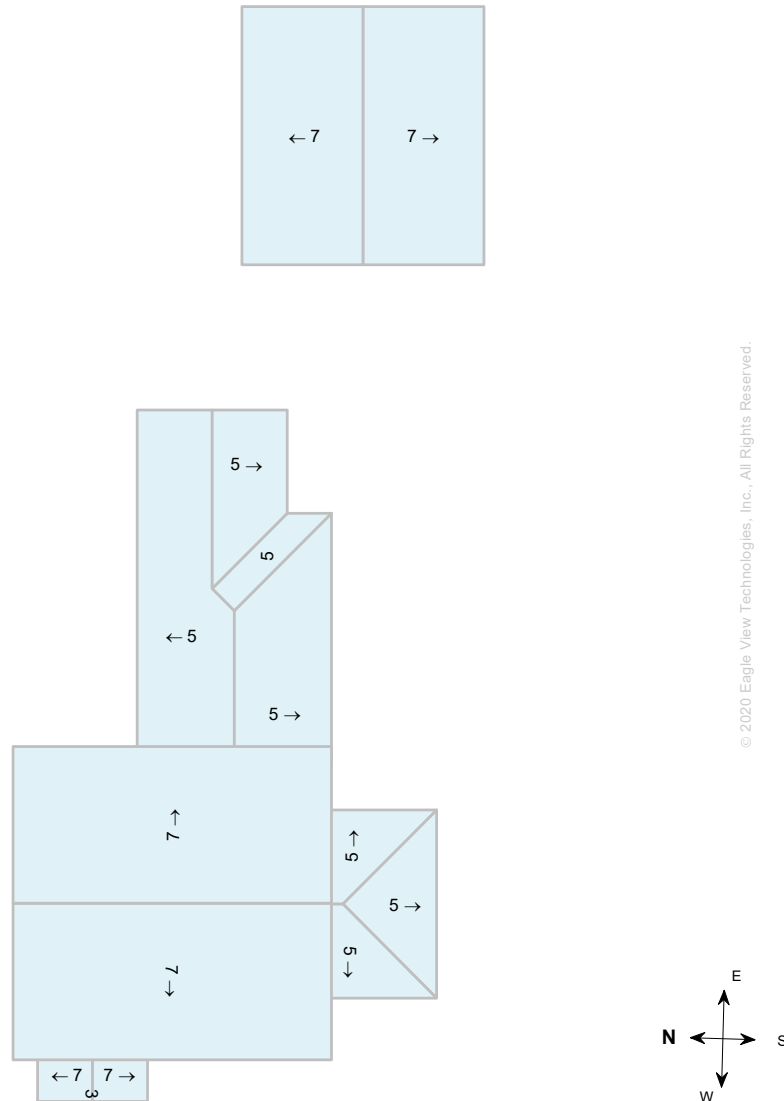

Note: This diagram contains labeled pitches for facet areas larger than 20.0 square feet. In some cases, pitch labels have been removed for readability. Blue shading indicates a pitch of 3/12 and greater.

123 MAIN ST., CITY, ST, 00000

Report: SAMPLE

AREA DIAGRAM

Total Area = 2,387 sq ft, with 14 facets.

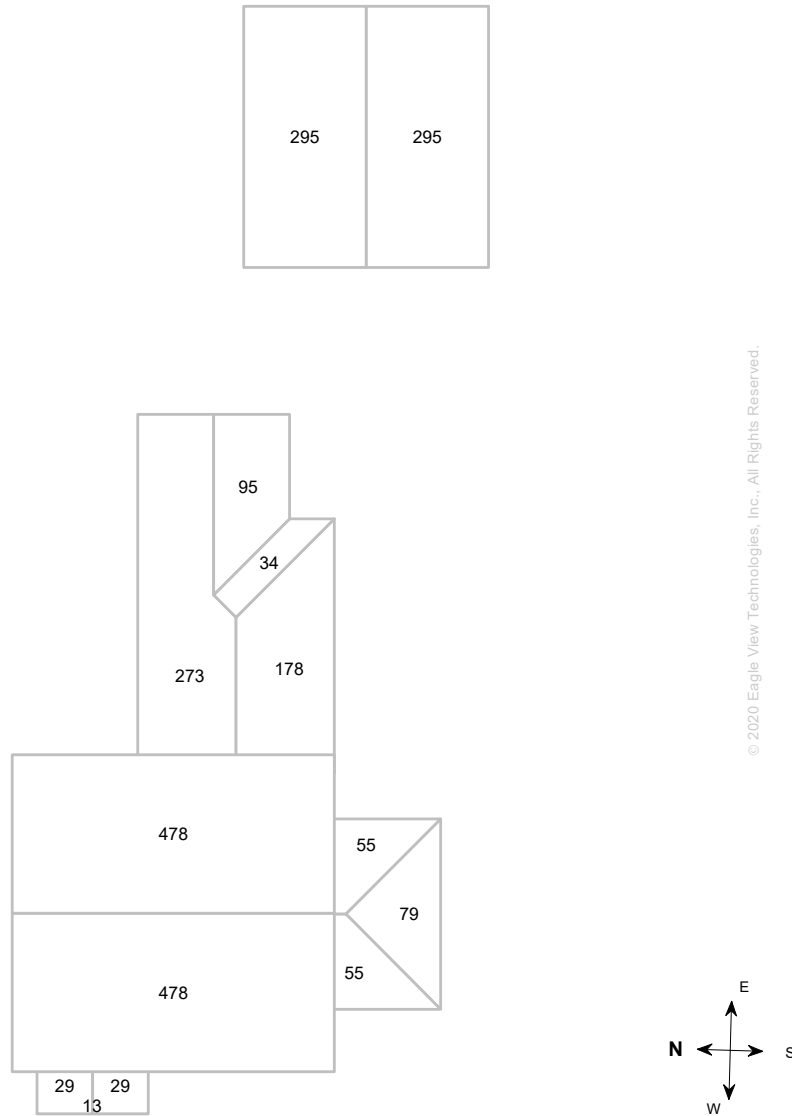

Note: This diagram shows the square feet of each roof facet (rounded to the nearest Foot). The total area in square feet, at the top of this page, is based on the non-rounded values of each roof facet (rounded to the nearest square foot after being totaled).

NOTES DIAGRAM

Roof facets are labeled from smallest to largest (A to Z) for easy reference.

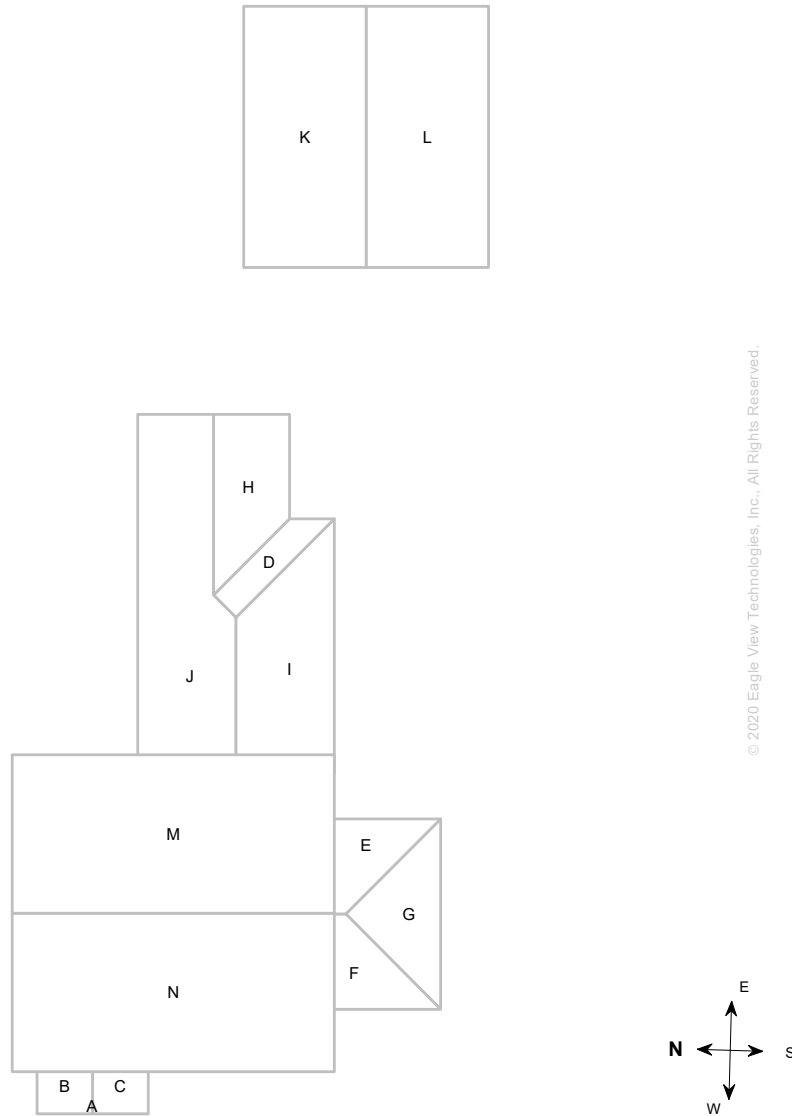

© 2020 Eagle View Technologies, Inc., All Rights Reserved.

123 MAIN ST., CITY, ST, 00000

Report: SAMPLE

WALL AREA DIAGRAM

Total Wall Area = 3,231 sq ft, with 17 facets.

Total Wall Area with Windows and Doors = 3,852 sq ft

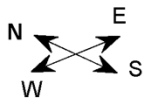
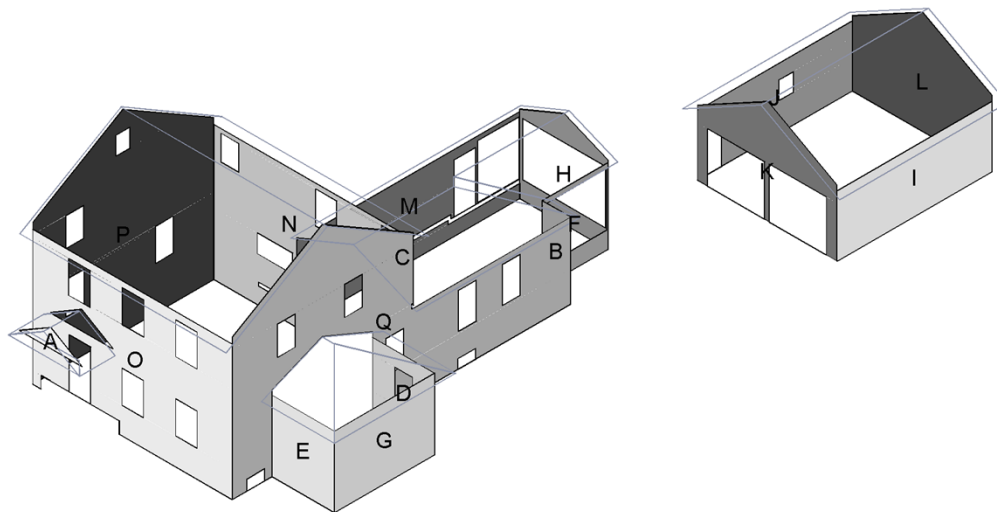

© 2020 Eagle View Technologies, Inc., All Rights Reserved.

Wall Area by Direction

<u>North</u>	<u>East</u>	<u>South</u>	<u>West</u>
C - 69.3 sq ft J - 159.5 sq ft M - 173.2 sq ft P - 555.1 sq ft	B - 42.8 sq ft D - 75.2 sq ft H - 63.5 sq ft L - 233.5 sq ft N - 272.2 sq ft	F - 30.8 sq ft G - 139.6 sq ft I - 185.4 sq ft Q - 599.6 sq ft	A - 11.2 sq ft E - 86.5 sq ft K - 121.3 sq ft O - 412.1 sq ft
957.1 sq ft	687.2 sq ft	955.4 sq ft	631.1 sq ft

123 MAIN ST., CITY, ST, 00000

Report: SAMPLE

ALTERNATE WALL AREA

Total Wall Area = 3,231 sq ft, with 17 facets.

Total Wall Area with Windows and Doors = 3,852 sq ft

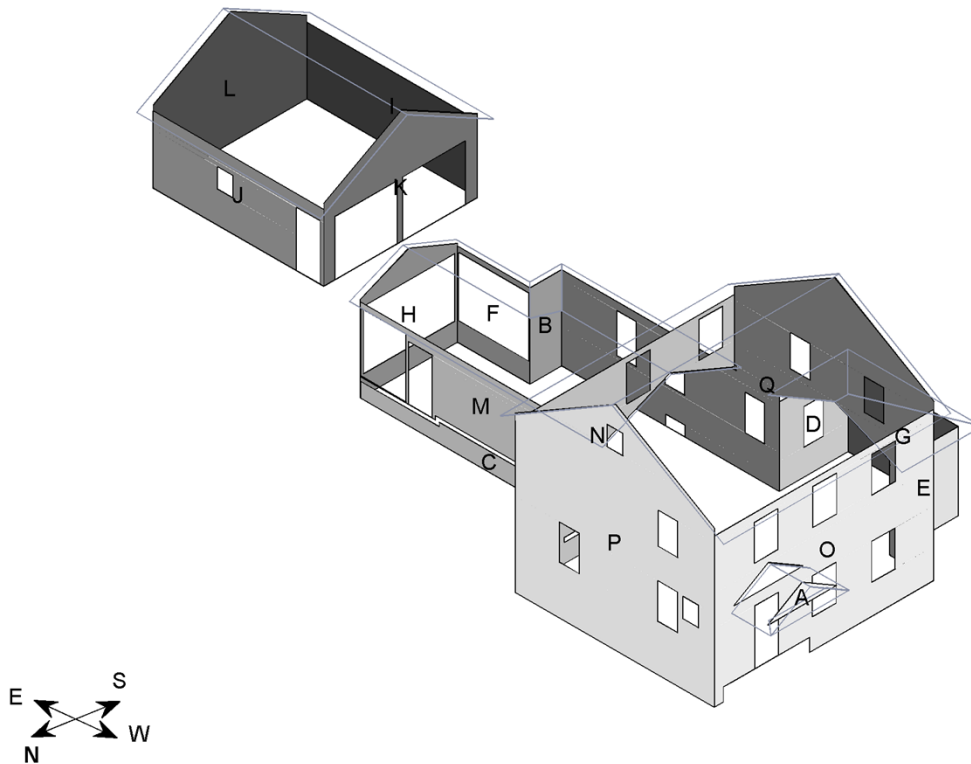

© 2020 Eagle View Technologies, Inc., All Rights Reserved.

Wall Area by Direction

<u>North</u>	<u>East</u>	<u>South</u>	<u>West</u>
C - 69.3 sq ft J - 159.5 sq ft M - 173.2 sq ft P - 555.1 sq ft	B - 42.8 sq ft D - 75.2 sq ft H - 63.5 sq ft L - 233.5 sq ft N - 272.2 sq ft	F - 30.8 sq ft G - 139.6 sq ft I - 185.4 sq ft Q - 599.6 sq ft	A - 11.2 sq ft E - 86.5 sq ft K - 121.3 sq ft O - 412.1 sq ft
957.1 sq ft	687.2 sq ft	955.4 sq ft	631.1 sq ft

123 MAIN ST., CITY, ST, 00000

Report: SAMPLE

WINDOW AND DOOR DIAGRAM

Total Window and Door Area = 621 sq ft, with 32 windows and doors

Total Window and Door Perimeter = 531 ft

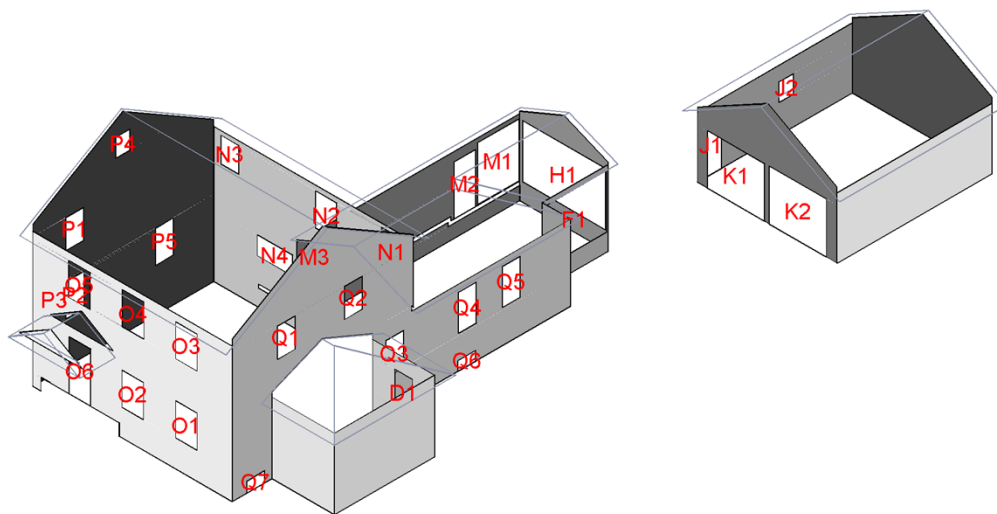

© 2020 Eagle View Technologies, Inc., All Rights Reserved.

Window and Door Measurements

<u>North</u>	<u>East</u>	<u>South</u>	<u>West</u>
J1 - 21 sq ft	D1 - 11.3 sq ft	F1 - 67.5 sq ft	K1 - 55.9 sq ft
J2 - 5 sq ft	H1 - 87.4 sq ft	Q1 - 10 sq ft	K2 - 56.3 sq ft
M1 - 43.2 sq ft	N1 - 13.5 sq ft	Q2 - 10 sq ft	O1 - 13.5 sq ft
M2 - 20.9 sq ft	N2 - 13.5 sq ft	Q3 - 11.3 sq ft	O2 - 13.5 sq ft
M3 - 10 sq ft	N3 - 8.8 sq ft	Q4 - 12.5 sq ft	O3 - 13.5 sq ft
P1 - 10 sq ft	N4 - 12.5 sq ft	Q5 - 12.5 sq ft	O4 - 13.5 sq ft
P2 - 11.3 sq ft		Q6 - 3.2 sq ft	O5 - 13.5 sq ft
P3 - 5 sq ft		Q7 - 3.7 sq ft	O6 - 20.9 sq ft
P4 - 5 sq ft			
P5 - 11.3 sq ft			

123 MAIN ST., CITY, ST, 00000

Report: SAMPLE

Window and Door Measurements continued...

<u>North</u>	<u>East</u>	<u>South</u>	<u>West</u>
142.7 sq ft	147 sq ft	130.7 sq ft	200.6 sq ft

123 MAIN ST., CITY, ST, 00000

Report: SAMPLE

NORTH ELEVATION DIAGRAM

Top of Walls = 114 ft
Bottom of Walls = 110 ft

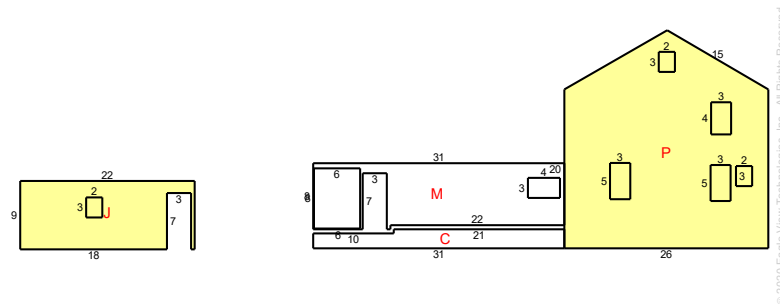

North Elevation Details

Wall	Wall Area	Window & Door Area	Window & Door Perimeter	Window & Door Count
C	69.3	0.0	0.0	0
J	159.5	26.0	29.0	2
M	173.2	74.1	59.6	3
P	555.1	42.6	59.0	5
Total	957.1 sq ft	142.7 sq ft	147.6 ft	10

Note: On-site verification of yellow shaded areas is needed. Details are on the Wall Report Summary Page. This diagram shows segment lengths rounded to the nearest whole number. The window & door and wall area in square feet (rounded to the nearest tenth) is based on the actual (non-rounded) value of each segment length.

123 MAIN ST., CITY, ST, 00000

Report: SAMPLE

EAST ELEVATION DIAGRAM

Top of Walls = 77 ft
Bottom of Walls = 85 ft

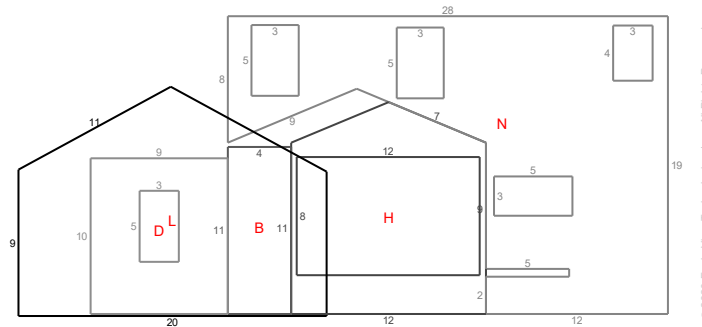

East Elevation Details

Wall	Wall Area	Window & Door Area	Window & Door Perimeter	Window & Door Count
B	42.8	0.0	0.0	0
D	75.2	11.3	14.0	1
H	63.5	87.4	38.4	1
L	233.5	0.0	0.0	0
N	272.2	48.3	57.0	4
Total	687.2 sq ft	147 sq ft	109.4 ft	6

Note: On-site verification of yellow shaded areas is needed. Details are on the Wall Report Summary Page. This diagram shows segment lengths rounded to the nearest whole number. The window & door and wall area in square feet (rounded to the nearest tenth) is based on the actual (non-rounded) value of each segment length.

123 MAIN ST., CITY, ST, 00000

Report: SAMPLE

SOUTH ELEVATION DIAGRAM

Top of Walls = 97 ft
Bottom of Walls = 94 ft

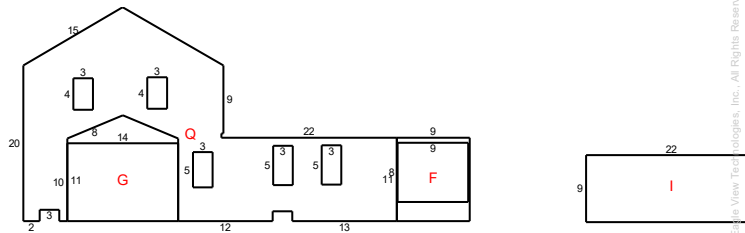

© 2020 Eagle View Technologies, Inc. All Rights Reserved.

South Elevation Details

Wall	Wall Area	Window & Door Area	Window & Door Perimeter	Window & Door Count
F	30.8	67.5	33.0	1
G	139.6	0.0	0.0	0
I	185.4	0.0	0.0	0
Q	599.6	63.2	85.6	7
Total	955.4 sq ft	130.7 sq ft	118.6 ft	8

Note: On-site verification of yellow shaded areas is needed. Details are on the Wall Report Summary Page. This diagram shows segment lengths rounded to the nearest whole number. The window & door and wall area in square feet (rounded to the nearest tenth) is based on the actual (non-rounded) value of each segment length.

WEST ELEVATION DIAGRAM

Top of Walls = 78 ft
Bottom of Walls = 76 ft

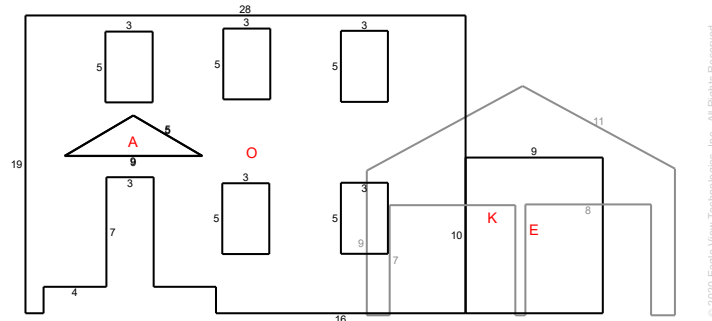

West Elevation Details

Wall	Wall Area	Window & Door Area	Window & Door Perimeter	Window & Door Count
A	11.2	0.0	0.0	0
E	86.5	0.0	0.0	0
K	121.3	112.2	60.0	2
O	412.1	88.4	95.0	6
Total	631.1 sq ft	200.6 sq ft	155 ft	8

Note: On-site verification of yellow shaded areas is needed. Details are on the Wall Report Summary Page. This diagram shows segment lengths rounded to the nearest whole number. The window & door and wall area in square feet (rounded to the nearest tenth) is based on the actual (non-rounded) value of each segment length.

123 MAIN ST., CITY, ST, 00000

Report: SAMPLE

REPORT SUMMARY

Structure #1

Areas per Pitch

Roof Pitches	7/12	5/12	3/12
Area (sq ft)	1014.3	769.9	13
% of Roof	56.4%	42.8%	0.7%

The table above lists each pitch on this roof and the total area and percent (both rounded) of the roof with that pitch.

Structure Complexity

Simple	Normal	Complex
--------	--------	---------

Waste Calculation

NOTE: This waste calculation table is for asphalt shingle roofing applications. All values in table below only include roof areas of 3/12 pitch or greater. For total measurements of all pitches, please refer to the **Lengths, Areas, and Pitches** section below.

Waste %	0%	5%	10%	13%	15%	17%	20%	25%	30%
Area (Sq ft)	1798	1888	1978	2032	2068	2104	2158	2248	2338
Squares *	18.00	19.00	20.00	20.33	21.00	21.33	21.66	22.66	23.66
	Measured				Suggested				

* Squares are rounded up to the 1/3 of a square.

Additional materials needed for ridge, hip, and starter lengths are not included in the above table. The provided suggested waste factor is intended to serve as a guide—actual waste percentages may differ based upon several variables that EagleView does not control. These waste factor variables include, but are not limited to, individual installation techniques, crew experiences, asphalt shingle material subtleties, and potential salvage from the site. Individual results may vary from the suggested waste factor that EagleView has provided. The suggested waste is not to replace or substitute for experience or judgment as to any given replacement or repair work.

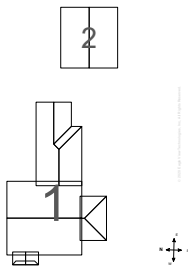

Total Roof Facets = 12

Lengths, Areas and Pitches

Ridges = 66 ft (5 Ridges)
Hips = 42 ft (4 Hips)
Valleys = 11 ft (1 Valleys)
Rakes† = 93 ft (8 Rakes)
Eaves/Starter‡ = 185 ft (12 Eaves)
Drip Edge (Eaves + Rakes) = 278 ft (20 Lengths)
Parapet Walls = 0 (0 Lengths)
Flashing = 8 ft (1 Lengths)
Step flashing = 54 ft (8 Lengths)
Predominant Pitch = 7/12
Total Area (All Pitches) = 1798 sq ft

Property Location

Longitude = -87.8801054
Latitude = 41.8051525

Notes

This was ordered as a residential property.

† Rakes are defined as roof edges that are sloped (not level).
‡ Eaves are defined as roof edges that are not sloped and level.

123 MAIN ST., CITY, ST, 00000

Report: SAMPLE

REPORT SUMMARY

Structure #2

Areas per Pitch	
Roof Pitches	7/12
Area (sq ft)	589.6
% of Roof	100%

The table above lists each pitch on this roof and the total area and percent (both rounded) of the roof with that pitch.

Structure Complexity		
Simple	Normal	Complex

Waste Calculation									
NOTE: This waste calculation table is for asphalt shingle roofing applications. All values in table below only include roof areas of 3/12 pitch or greater. For total measurements of all pitches, please refer to the Lengths, Areas, and Pitches section below.									
Waste %	0%	3%	8%	11%	13%	15%	18%	23%	28%
Area (Sq ft)	590	608	638	655	667	679	697	726	756
Squares *	6.00	6.33	6.66	6.66	7.00	7.00	7.00	7.33	7.66
	Measured				Suggested				

* Squares are rounded up to the 1/3 of a square.

Additional materials needed for ridge, hip, and starter lengths are not included in the above table. The provided suggested waste factor is intended to serve as a guide—actual waste percentages may differ based upon several variables that EagleView does not control. These waste factor variables include, but are not limited to, individual installation techniques, crew experiences, asphalt shingle material subtleties, and potential salvage from the site. Individual results may vary from the suggested waste factor that EagleView has provided. The suggested waste is not to replace or substitute for experience or judgment as to any given replacement or repair work.

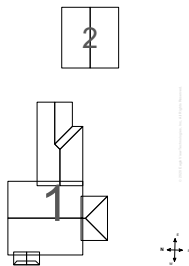

Total Roof Facets = 2

Lengths, Areas and Pitches

Ridges = 24 ft (1 Ridges)
Hips = 0 ft (0 Hips).
Valleys = 0 ft (0 Valleys)
Rakes† = 52 ft (4 Rakes)
Eaves/Starter‡ = 47 ft (2 Eaves)
Drip Edge (Eaves + Rakes) = 99 ft (6 Lengths)
Parapet Walls = 0 (0 Lengths).
Flashing = 0 ft (0 Lengths)
Step flashing = 0 ft (0 Lengths)
Predominant Pitch = 7/12
Total Area (All Pitches) = 590 sq ft

Property Location

Longitude = -87.8801054
Latitude = 41.8051525

Notes

This was ordered as a residential property.

† Rakes are defined as roof edges that are sloped (not level).
‡ Eaves are defined as roof edges that are not sloped and level.

123 MAIN ST., CITY, ST, 00000

Report: SAMPLE

REPORT SUMMARY

All Structures

Areas per Pitch			
Roof Pitches	3/12	5/12	7/12
Area (sq ft)	13.0	769.8	1603.8
% of Roof	0.5%	32.2%	67.2%

The table above lists each pitch on this roof and the total area and percent (both rounded) of the roof with that pitch.

All Structures Totals

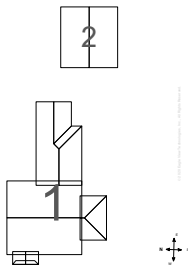

Total Roof Facets = 14

Lengths, Areas and Pitches

Ridges = 90 ft (6 Ridges)
 Hips = 42 ft (4 Hips).
 Valleys = 11 ft (1 Valleys)
 Rakes[†] = 144 ft (12 Rakes)
 Eaves/Starter[‡] = 232 ft (14 Eaves)
 Drip Edge (Eaves + Rakes) = 376 ft (26 Lengths)
 Parapet Walls = 0 (0 Lengths).
 Flashing = 8 ft (1 Lengths)
 Step flashing = 54 ft (8 Lengths)
 Predominant Pitch = 7/12
Total Area (All Pitches) = 2,387 sq ft

Property Location

Longitude = -87.8801054
 Latitude = 41.8051525

Notes

This was ordered as a residential property.

Measurements by Structure

Structure	Area (sq ft)	Ridges (ft)	Hips (ft)	Valleys (ft)	Rakes (ft)	Eaves (ft)	Flashing (ft)	Step Flashing (ft)	Parapets (ft)
1	1797	66	42	11	93	185	8	54	0
2	590	24	0	0	52	47	0	0	0

All values in this table are rounded up to the nearest Foot for each separate structure. Measurement totals displayed elsewhere in this report are added together before rounding which may cause totals to differ.

The table above lists each pitch on this roof and the total area and percent (both rounded) of the roof with that pitch.

Online Maps

Online map of property

http://maps.google.com/maps?f=g&source=s_q&hl=en&geocode=&q=447+S+PARK,LA+GRANGE,IL,60525

Directions from Renoworks to this property

http://maps.google.com/maps?f=d&source=s_d&saddr=2721+Hopewell+Pl+NE,Calgary,AB,T1Y7J7&daddr=447+S+PARK,LA+GRANGE,IL,60525

† Rakes are defined as roof edges that are sloped (not level).

‡ Eaves are defined as roof edges that are not sloped and level.

WALL REPORT SUMMARY

Wall Area Waste Calculation Table (excluding windows and doors)

Waste %	0%	10%	11%	12%	13%	14%	15%	20%
Area (sq ft)	3,231	3,554	3,586	3,619	3,651	3,683	3,716	3,877
Squares	32.3	35.5	35.9	36.2	36.5	36.8	37.2	38.8

This table shows the total wall area excluding windows and doors, based upon different waste percentages. The waste factor is subject to the complexity of the structure, image quality, siding techniques and your experience. Please consider this when calculating appropriate waste percentages. Note that only the wall area is included in these waste calculations. Accessories may require additional material.

Report Comments

Due to obstructions in available images of this property, please verify measurements on portion of structure highlighted in yellow.

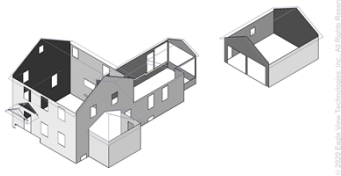

Total Lengths & Areas

Wall Area = 3,231 sq ft
 Wall Area with Windows and Doors = 3,852 sq ft
 Top of Walls = 366 ft
 Bottom of Walls = 364 ft
 Inside Corners = 43 ft
 Outside Corners = 159 ft
 Inside Corners > 90° = 0 ft
 Outside Corners > 90° = 0 ft
 Window and Door Area = 621 sq ft
 Window and Door Perimeter = 531 ft

Total Wall Facets = 17
 Total Windows and Doors = 32

Wall measurements should be field verified to confirm accuracy. Wall areas assume that flat soffits exist at the eaves. If sloped soffits are present, wall height and wall area measurements will likely be off.